

Preliminary

Color Camera Block with 4K/60p output Both Day and Night

4K STARVIS 2

The FCB-ER9500 features Sony's STARVIS™ 2 image sensor, for outstanding image quality in extreme low light environments as well as in the brightest lit conditions.

With the 25x optical zoom, capture incredible detail in 4K high-resolution, 60 frame per second video, from wide-angle to the telephoto end.

Easily expand your line-up with 4K, 4M, and full HD models, all designed in the same light weight, compact body, helping to lower system development costs.



HDMI*
25x Optical Zoom

4K/60p output

1/1.8-type Image Sensor

High Sensitivity

Super Image Stabilizer

WDR

HDMI*

ICR ON COLOR

Spot Focus/AE/AWB

Smooth, high-definition image with 4K/60p output

Improved clarity and detail in low-light conditions with 4K 1/1.8-type high sensitivity image sensor.

Reliable inner-zoom system with 4K 25x optical zoom

Security

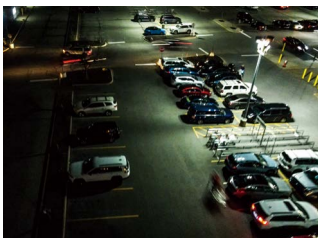

With 25x optical zoom, the FCB-ER9500 provides an image without deterioration in image quality even at the telephoto end. Get clear images in low-light, or in the brightest conditions, helping to better secure high-risk spaces, enhance public safety and enterprise security.

Remote



With high resolution video, the FCB-ER9500 provides students or co-workers with a sense of presence as if they were in the classroom helping to overcome the barriers of remote instruction, as well as improved hybrid collaboration.

Inspection



Identify even the slightest abnormalities with high resolution images and zoom capability. The FCB-9500 provides detailed observation in remote areas, on the tallest structures, and underwater, typically not easily accessible in a safe and efficient manner.

Medical Monitoring



As a surgical camera, the FCB-ER9500 can capture an image of an affected area clearly and shoot movement during surgery smoothly and naturally. It contributes to confirmation of a surgical field and recording of surgery.

* Video is output in the TMDS signal format used by HDMI.

Specifications

FCB-ER9500

Basic Specifications	
Image Sensor (Number of effective pixels)	1/1.8-type STARVIS™2 CMOS Sensor (Approx. 8.40M pixels)
Output Image Size (H × V)	3840 × 2160, 1920 × 1080, 1280 × 720
Signal System	2160p/60, 2160p/59.94, 2160p/50, 2160p/30, 2160p/29.97, 2160p/25, 1080p/60, 1080p/59.94, 1080p/50, 1080p/30, 1080p/29.97, 1080p/25, 1080i/60, 1080i/59.94, 1080i/50, 720p/60, 720p/59.94, 720p/50, 720p/30, 720p/29.97, 720p/25
Minimum Illumination (50%, High Sensitivity Mode ON)	TBD
Minimum Illumination (50%, High Sensitivity Mode OFF)	TBD
Recommended Illumination	100 lx to 100,000 lx
Image S/N	50 dB (Weight On)
Gain	Auto/Manual (0 dB to 50.0 dB), 0 to 28 steps
Shutter Speed	1/1 to 1/10000 s, 22 steps
Sync System	Internal
Exposure Control	0 dB to ± 10.5 dB, 15 steps
Backlight Compensation	Yes
Gamma	Standard / Straight gamma
Aperture Control	16 steps
White Balance	Auto, ATW, Indoor, Outdoor, One Push WB, Manual WB, Outdoor Auto, Sodium Vapor Lamp (Fix/Auto/Outdoor Auto), Spot AWB
AE (Auto Exposure Mode)	Full Auto, Manual, Priority mode (shutter/iris), EV compensation, Spot AE, Slow AE
Zoom	25x Optical Zoom, 30x StableZoom*1, 12x Digital Zoom
Lens (wide to tele)	25x Optical Zoom Lens f = 6.5 mm to 162.5 mm, F1.6 to 4.8
Zoom Mode	Standard Mode / Variable Mode / Direct Mode
Zoom Movement Speed	TBD
	TBD
	TBD
Focusing System	Auto Focus (Normal AF, Interval AF, Zoom Trigger), AF Sensitivity (normal, low), Manual (Standard, Variable, Direct), One Push Trigger, Full Scan One Push Trigger, Near Limit, ICR-on Correction, Spot Focus
Focus Movement Time	TBD
Horizontal Viewing Angle	TBD
Minimum Object Distance (wide end to tele end)	100 mm to 1200 mm
Camera Features	
Auto ICR	Yes:ON (B&W / Color)
Wide Dynamic Range (Wide-D)	Yes
Visibility Enhancer	Yes
Defog	Yes (low/mid/high)
Noise Reduction	Yes (3D + 2D / Independent setting (3D, 2D))
Image Stabilization	Yes: Super image stabilizer (Super / Super+)
Spot Light Avoidance	Yes
Motion Detection	Yes
Privacy Zone Masking	Yes
Alarm	Yes
Slow AE Response	Yes
Picture Effects	Monochrome
Picture Freeze	Yes
Electronic-Flip (E-FLIP)	Yes
Mirror Image	Yes
Slow Shutter	Yes
Temperature Readout	Yes
Title Display	Yes (20 characters / line, max. 11 lines)
Camera Mode Display	Yes (English)
Interface	
Video Output	Digital : Y/Pb/Pr 4:2:2 (HDMI*2) Y:8bit, C:8bit, RGB 4:4:4 (HDMI*2) R:8bit G:8bit B:8bit
Camera Control Interface	VISCA protocol (CMOS 3.3V Level, 5.5V tolerance); Baud Rate : 9.6 kbps, 19.2 kbps, 38.4 kbps, 115.2 kbps, Stop bit: 1 bit
General	
Power Requirements	7.0 V to 12.0 V DC
Power Consumption	TBD
Operating Temperature	-5 °C to +60 °C (23 °F to +140 °F)
Storage Temperature	-20 °C to +60 °C (-4 °F to +140 °F)
Operating Humidity	20% to 80% (Absolute humidity: 36 g/m ³)
Storage Humidity	20% to 95% (Absolute humidity: 36 g/m ³)
Dimensions (W × H × D)	56 × 64 × 125 mm (2 1/4 × 2 5/8 × 5 in.)
Mass	TBD

*1 StableZoom increases the magnification by combining optical zoom and digital zoom.

*2 Video is output in the TMDS signal format used by HDMI.

Dimensions · Connector

Front

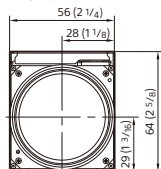

Unit: mm (inches)

Right side

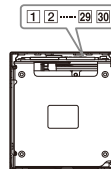
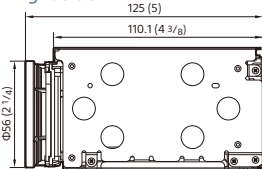

Digital output connector

Digital output connector
KEL Co. USL00-30L-C

Distributed by

MK52401V1YIT24MAY

©2024 Sony Corporation

Reproduction in whole or in part without written permission is prohibited. Features and specifications are subject to change without notice.

The values for mass and dimensions are approximate.

"Sony", "SONY" logo and any other product names, service names or logo marks used in this website are registered trademarks or trademarks of Sony Group Corporation or its affiliates. Other product names, service names, company names or logo marks are trademarked and copyrighted properties of their respective owners and/or licensors.

All other trademarks are the property of their respective owners.

Please visit Sony's professional website or contact your Sony representative for specific models available in your region.